

Type A Gp. Jersey International  
Winner by Whitehead 1950 # 10

Body color  
English Green

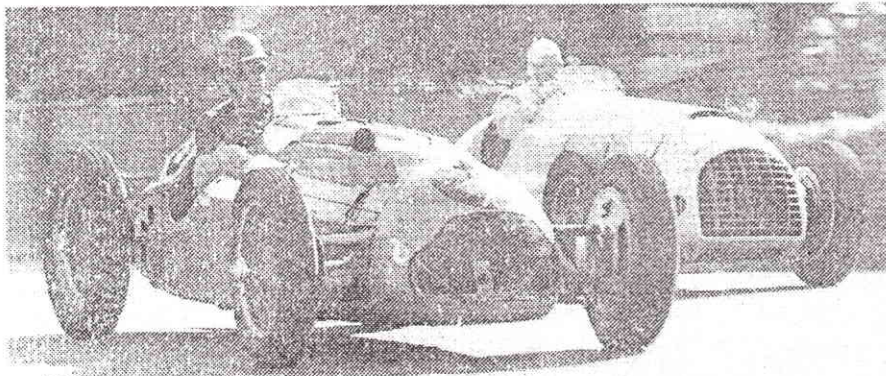

Type B Gp. Monaco 1950  
Driver R. Sommer # 42

Body color  
Blue Cannes

# MG Model

Art. 20.07

Ferrari 125 F. 1

Scala 1 : 20

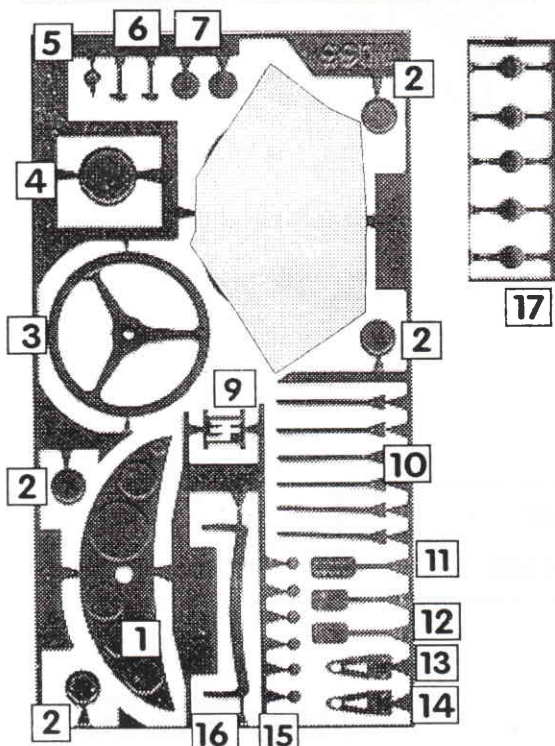
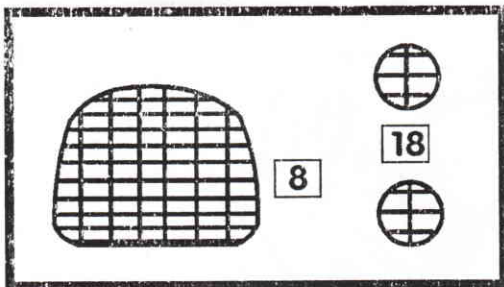
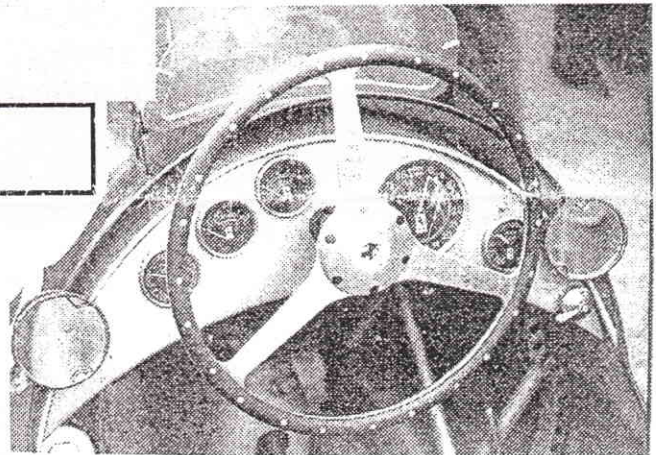
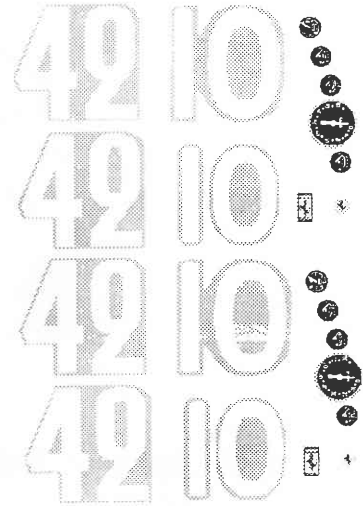

## Attenzione !

Prima di fissare i pezzi controllare il perfetto adattamento ed incastro e se necessario, forate carteggiate o stuccate ogni parte prima di verniciare. Lavare ogni pezzo di resina con sgrassante antisiliconico prima di verniciare. Date una mano di filler prima di dare il colore definitivo.

## Warning!

Before fit pieces together, try the correct fit and position and if necessary, drill, sandpaper or putty, before painting. Wash each resin part with antisliliconic degreaser, before painting. Paint part with filler before apply the correct color.

## Note :

- 1) Tutti i pezzi possono essere incollati con cianoacrilato, araldite o colla epossidica, tranne le parti trasparenti.
- 2) Le parti trasparenti possono essere incollate con colla vinilica o colla speciale per pvc trasparente.
- 3) Un ammorbidente per decals è indicato per facilitare il posizionamento delle decals più grandi.
- 4) Per forare o allargare un foro, usate un trapanino a bassa velocità .
- 1) Cyanoacrilate cement, epoxy cement or araldite can be used for all part, except pvc transparent parts.
- 2) Pvc transparent parts can be cement with vinilic or gummy glue.
- 3) Soften decals solution is recommended for decals application.
- 4) to make or enlarge holes, use carefully a low speed drill or a pin vise.

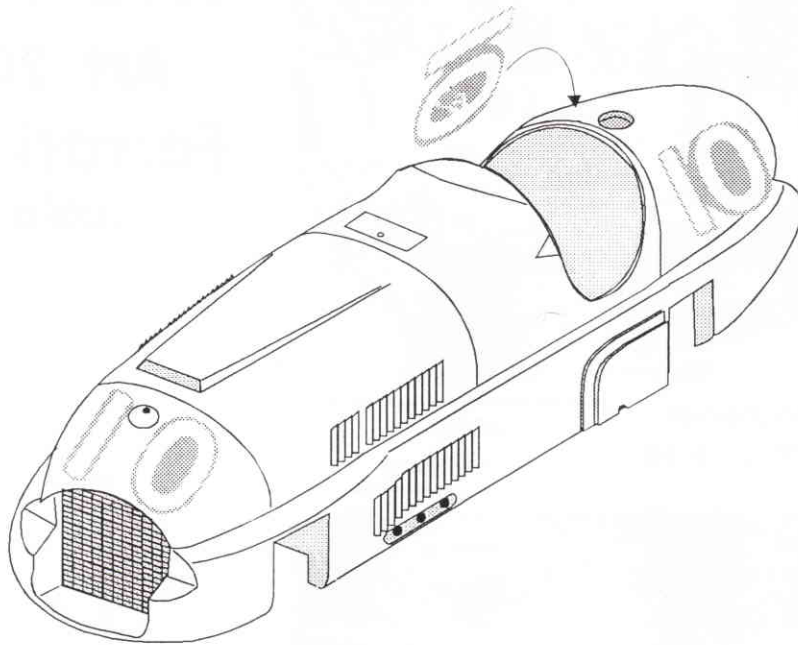

**Type A Gp. Jersey International  
Winner by Whitehead 1950 # 10**

**Body color  
English Green**

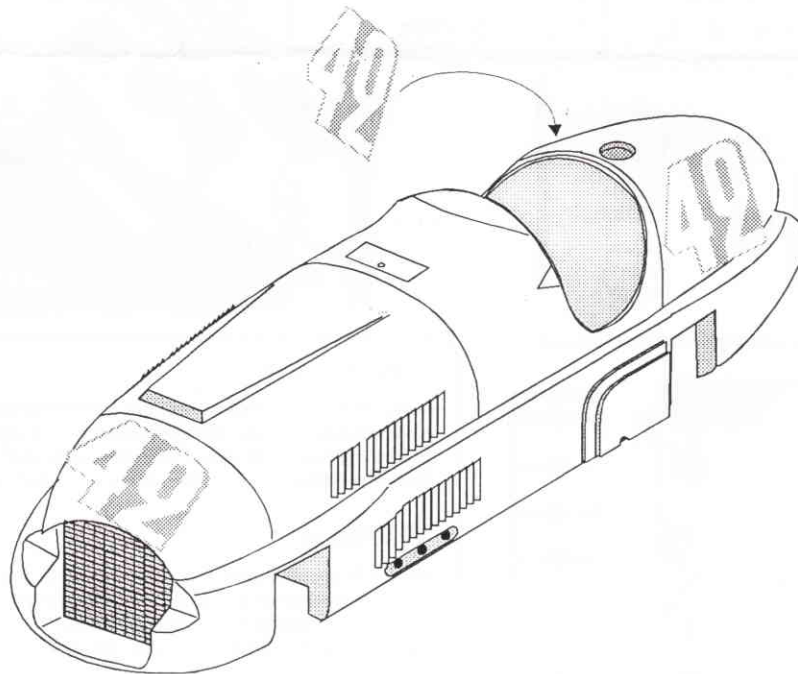

**Type B Gp. Monaco 1950  
Driver R. Sommer # 42**

**Body color  
Blue Cannes**

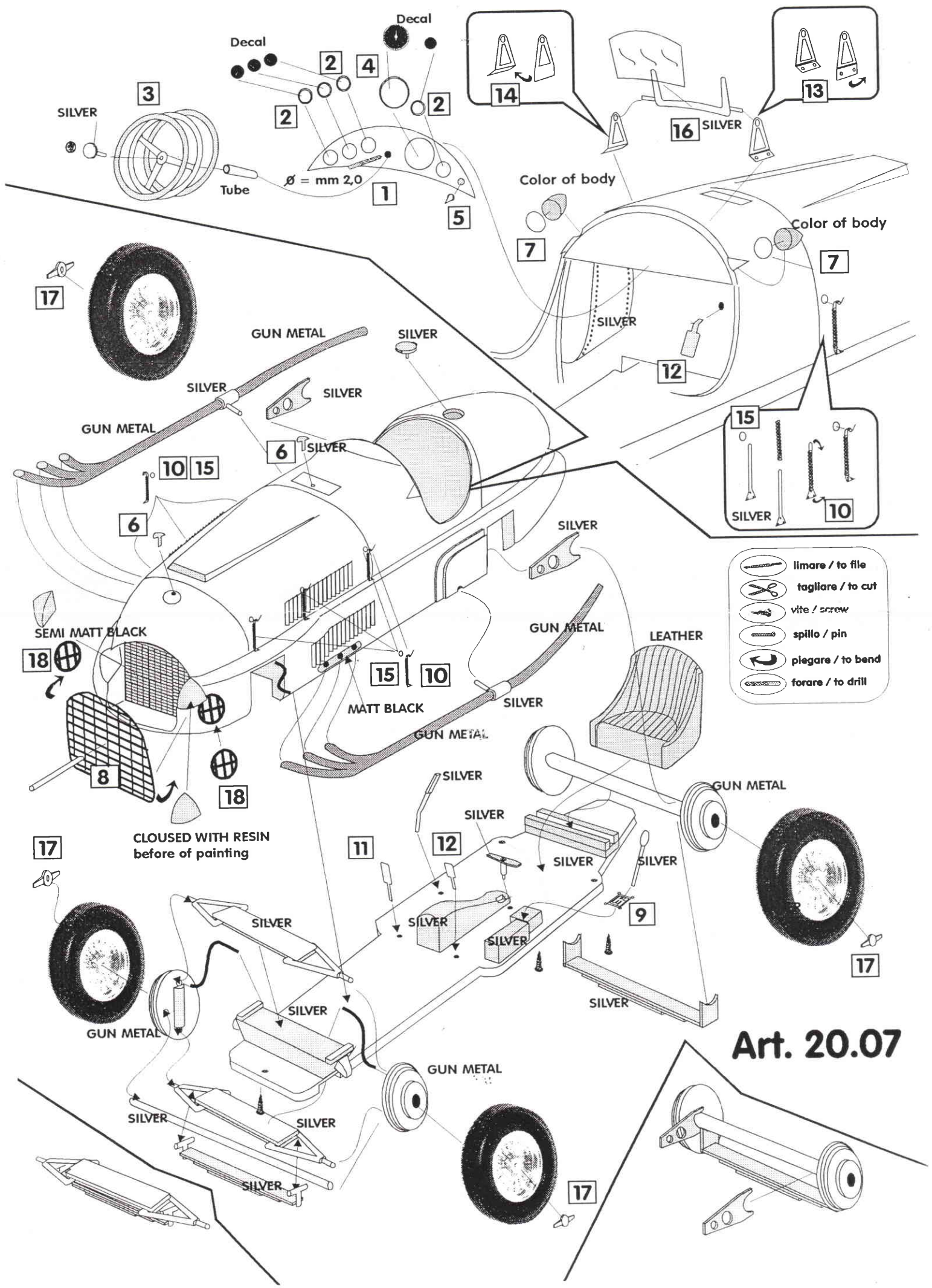

SILVER

Decal

Decal

Tube

∅ = mm 2,0

Color of body

Color of body

GUN METAL

SILVER

SILVER

SILVER

GUN METAL

SILVER

SILVER

GUN METAL

LEATHER

SEMI MATT BLACK

MATT BLACK

GUN METAL

SILVER







GUN METAL

CLOUSED WITH RESIN before of painting

GUN METAL

GUN METAL

Art. 20.07

-  limare / to file
-  tagliare / to cut
-  vite / screw
-  spillo / pin
-  piegare / to bend
-  forare / to drill