



RACE-CRAFT MODELS

T51

Cooper-Climax
works team.
Jack Brabham,
Monaco Grand Prix, 1959.

1/20 Scale PARTS LIST

No.	Description	Qty	No.	Description	Qty
1	Body	1	22	Front susp. 'A' arm - bottom	2
2	Cockpit side panel - left	1	23	Front anti-roll links	2
3	Cockpit side panel - right	1	24	Front susp. wishbone - top	2
4	Chassis cross member	1	25	Front suspension uprights	2
5	Cockpit floor	1	26	Steering arms	2
6	gear shift lever	1	27	Front track rods	2
7	Handbrake lever	1	28	Carburettor trumpets	1
8	Dash board	1	29	Carburettor cover	1
9	seat	1	30	Rear view mirrors	2
10	Steering wheel	1	31	Fuel filler caps	2
11	Rear susp. mounting - left	1	32	Spring clips	2
12	Rear susp. mounting - right	1	33	Exhaust pipe	1
13	Rear susp. 'A' arm, bottom	2	34	Disc brake and calliper - left	2
14	Shock absorber - body	4	35	Disc brake and calliper - right	2
15	Shock absorber - top	4	36	Front wheel rim with tyre	2
16	Drive shafts	2	37	Rear wheel rim with tyre	2
17	Rear suspension, upright	2	38	Windscreen - front	1
18	Rear susp. 'A' arm, top	2	39		
19	Rear leaf springs	2	40		
20	front susp. mounting - left	1	41		
21	Front susp. mounting - right	1	42		

Painting guide.

This is a rough guide only as these cars raced in the hands of privateers as well as the works team. They also enjoyed long careers in other race series in several countries. Check references for the particular car you wish to model.

Dark Blue/Dark green -	Body and carburetor cover.
Gloss White -	Wheels, nose stripe and tail fin.
Satin Black -	Shock absorbers and springs, leaf springs, dashboard, steering wheel rim, seat, and tyres.
Silver Grey Metallic -	All suspension parts, disc brakes and calipers, drive shafts, mirrors, steering arms, track rods, handbrake lever, gearshift lever, steering wheel spokes, cockpit, gauge bezels, switches.
Dove Grey -	All chassis parts.
Matt Grey -	Exhaust pipe.

Preparation

Please check you have all the parts against the list supplied. Familiarise yourself with the parts and instructions before commencing construction. Gather references and check them regularly. Clean all parts in a mild detergent, scrub gently with an old toothbrush then air dry.

Remove resin 'pour tabs' with a razor saw and clean up with files and wet and dry Emery paper, use cutters and needle files to clean mould lines and flash from all parts. Take care to avoid inhaling or ingesting resin dust or metal filings.

1:20 scale multimedia kit, decals for one car.

**1:20
SCALE**

Produced by
Coastal Craft
26 Turner Close,
Jump, Barnsley S74 0LF
tel: +44 (0) 1226 350241
e-mail: coastalcraftmodels@gmail.com

**RACE-CRAFT
RC 20-01**

Wash all parts a second time and prime with good quality primer. This will improve the adhesion of paint and quality of finish.

Paint small parts and details as you build up sub assemblies, detail painting cannot be done after construction is complete.

This model is not intended for novice modelers or children under 12 years of age, it should however, be straightforward for those with moderate levels of skill and experience

Construction.

Step 1. Cockpit.

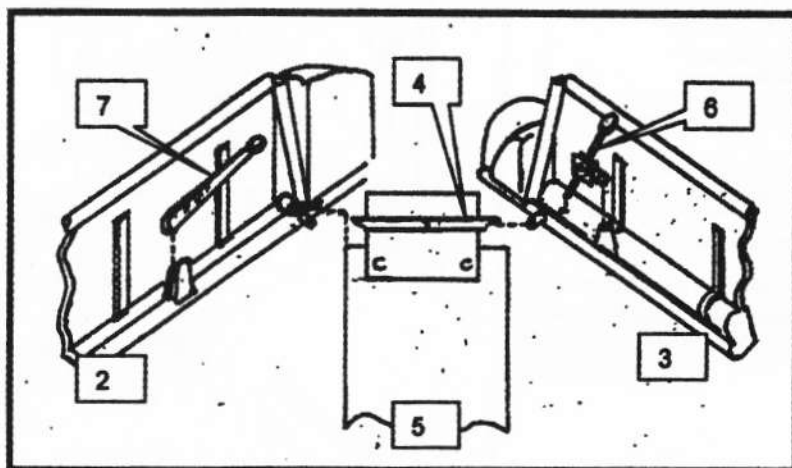

Ease the left and right cockpit sides (2 & 3) into place and add the chassis cross member (4) that fits on the pins at the base of the main down tubes.

Insert the cockpit floor (5) from underneath the body, between the cockpit side panels and in front of the cross member, then ease the rear end up into the opening. Fill and sand as required.

Fit the gearshift lever (6) to the right cockpit side panel. The bottom of the lever locates into the hole in the chassis, the boss on the linkage mechanism fits on top of the post to the right of the gear lever locating hole (see illustration). A length of 15 amp. fuse wire should be attached at one end to the collar and at the other end in the small hole in the cockpit rear wall.

Fit the handbrake lever (7) into the bracket on the chassis rail of the left cockpit side panel, it should be angled up at approx 45 degrees when brake is applied. A fine wire may be added from the adjuster assembly on the lower chassis rail to the clamp on the hand brake lever. Now fit the dashboard (8), on the chassis cross member under the cockpit lip, angled to face up to the driver. Fit the seat (9) and steering wheel (10) to complete the cockpit.

Step 2. Rear suspension. *See illustration below.*

Except for the mounting plates (11 & 12) all the parts for the left and right rear suspension units are a mirror image and can be 'flipped over' or turned around.

Put the mounting plate (11) on a flat surface and fit the lower 'A' arm (13) at 90° vertically. The angled arm goes towards the front. The thick collar on the 'A' arm cross member should then line-up up with the two brackets at the front and top of the mounting plate (11).

The shock absorber will fit to the collar on the 'A' arm and to the bracket on the mounting plate. See illustration. Drill centrally both the shock absorber body (14) and the shock absorber top (15) to receive a 15amp. fuse wire rod. Drill the collar on the 'A' arm cross member to accept the pin on the shock absorber body. Check and adjust for length and then fit the completed shock absorber. Ensure this unit is very secure, as much of the weight of the model will be carried on these units.

Next fit the drive shaft (16) with the end with the disc to the mounting plate. Add the upright (17); top 'A' arm (18) and leaf spring (19).

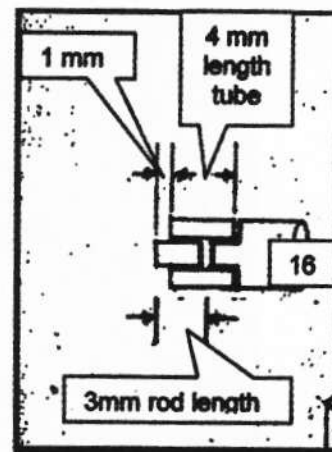
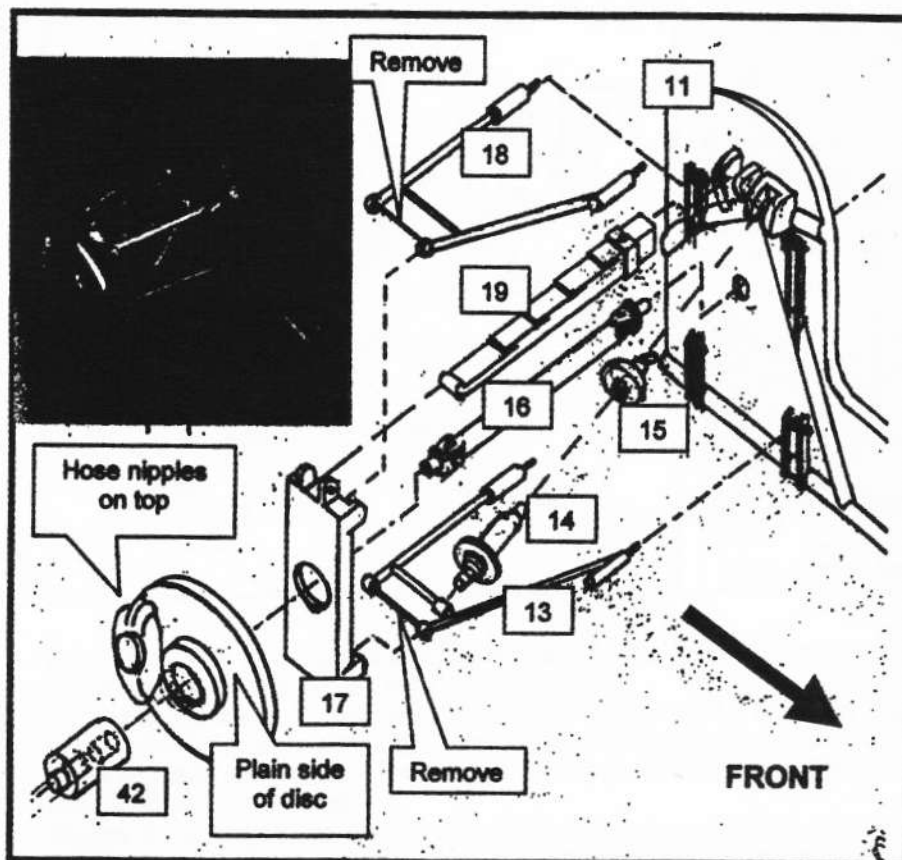

Alternative to cutting and drilling supplied stub axle (42). Make from plastic tube and rod to drawing above.

The stub axle (42), as supplied, is over length and requires shortening and drilling centrally to fit. Reduce the thick portion to a length of 4 mm, leaving the shouldered length at 1mm, and drill centrally to fit over the pin at the end of the drive shaft. Fit, BUT DO NOT SECURE the stub axle. Now fit the disc brake and caliper (34) and check the stub axle for length. Only the shoulder portion of the stub axle should protrude through the brake disc. Adjust the length of the stub axle if required. Note that there are left and right hand disc brake units. Correctly fitted the disc brake should have the two mounting arm details against the upright with the two nipples on the calipers for the brake hose connections on top. See illustration in Step 3. Repeat these instructions for the right hand side using mounting plate (12). To enable you to match the left hand side and achieve a level stance for the model, sufficient space has been allowed in the suspension apertures to allow adjustment of the mounting plate and complete suspension unit.

Step 3. Front suspension. See illustration below.

Fit to the left hand front mounting plate (20) the bottom 'A' arm (22) in the same manner as for the rear suspension unit.

Drill the mounting plate to accept the pin on the shock absorber body (14). As for the rear suspension unit drill the shock absorber body (14) and the top (15) to accept a 15 amp. fuse wire rod. Make a coil spring to fit over the absorber body (14). Ensure this unit is very secure, as much of the weight of the model will be carried on these units.

Fit the pin on the anti-roll link (23) in the location hole in the bottom right corner of the mounting plate (20) and to the boss on the front leg of the 'A' arm (22).

Fit the top wishbone (24) and the front up-right (25). The up-right fits on the pins on the wishbone at the top and the 'A' arm at the bottom. These location holes may need drilling or cleaning-up to fit and to obtain the vertical position required.

Drill the steering arm (26) to receive the track rod (27). It is recommended that the steering arm is drilled and pinned in position for strength. Fit the steering arm pointing down so that the track rod,

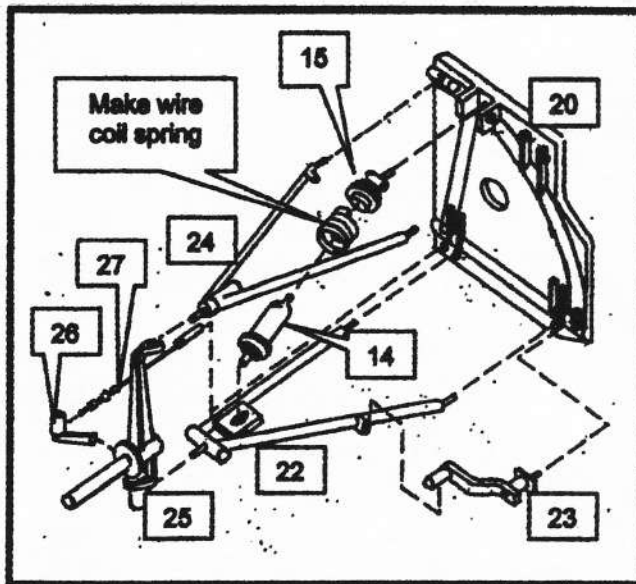

when fitted in its steering arm locating hole and in the hole in the bottom left hand corner of the mounting bracket, will run in a near horizontal plane.

Fitting the disc brake unit requires a length of plastic tube to be fitted over the stub axle on the up-right. Then fit the brake disc over the tube and trim away any excess plastic tube. This is similar to the stub axle alternative method suggested for the rear wheels. Cut the stub axle to length to fit into the recess in the wheel.

Repeat these instructions for the right hand side using mounting plate (21). To enable you to match the left hand side and achieve a level stance for the model, sufficient space has been allowed in the suspension apertures to allow adjustment of the mounting plate and complete suspension unit. To obtain the correct track width you can skim some resin from the suspension apertures so that the mounting plates fit further into the body.

Ensure this unit is very secure, as much of the weight of the model will be carried on these units.

Step 4. Final assembly.

Fit the carburetor unit (28) in the slot to the left rear of the cockpit and is only needed when the carburetor cover (29) is opened up. The car ran with several different versions of the carburetor cover so check your references. The kit part should be very easy to convert to most of the common versions.

The mirrors (30) locate in the holes just behind the front suspension openings.

The position of the fuel filler caps (31) are obvious, but note that the hinges go to the rear.

The rear body-work spring fasteners (32) fit in the holes just behind the cockpit.

The exhaust pipe (33) locates in holes in the right rear suspension opening and runs beneath the suspension lower 'A' arm.

Note.

It is suggested that the model is supported beneath the body, as over a period of time the weight of the body may tend to bend the metal suspension parts.

Collectors model kit not suitable for children under the age of 12 years.

